

TOP

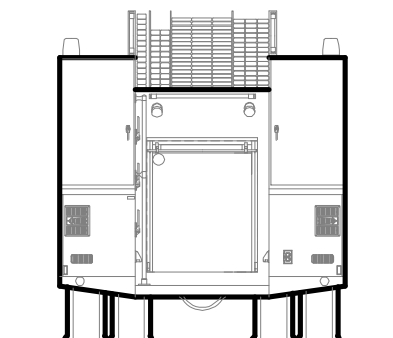

REAR

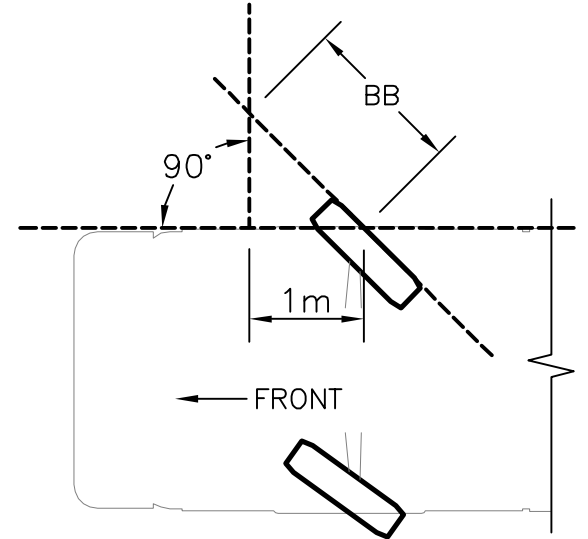

INSIDE TIRE STEERING
ANGLE HYPOTENUSE
LENGTH

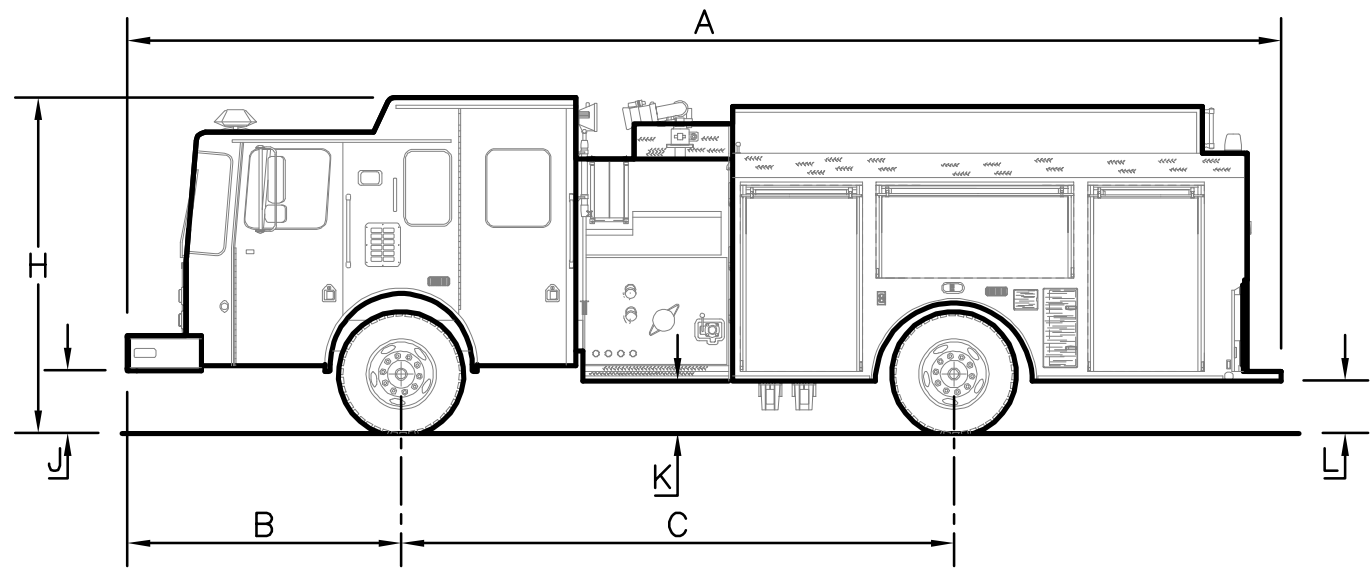

SIDE

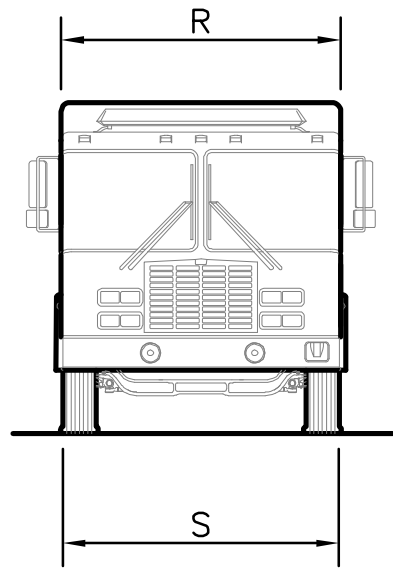

FRONT

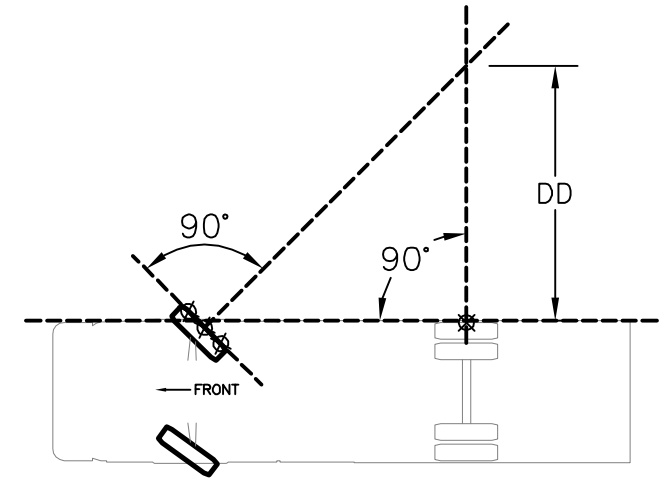

INNER TURN RADIUS

A	10,327 mm	U	2,510 mm			VEHICLE NAME:	Engine - E3
B	2,436 mm	BB	1,235 mm			VEHICLE TYPE:	PUMPER
C	5,555 mm	DD	7,475 mm			MANUFACTURER:	Fort Garry Fire Trucks
H	3,310 mm					VIN:	4S7RU2D90278231
J	520 mm					CITY/COUNTY:	Swift Current
K	250 mm					STATE/PROV.:	SK
L	453 mm					COUNTRY:	CA
R	2,485 mm					DATA COLLECTION BY:	B - Platoon
S	2,560 mm					DATE OF COLLECTION:	April 14, 2017
						FRONT TIRE DIAMETER & WIDTH:	1,072 mm X 385 mm
						REAR TIRE DIAMETER & WIDTH:	1,092 mm X 290 mm
						MIN. CURB-TO-CURB TURN RADIUS:	9,010 mm